

PROJECT INFORMATION

PROJECT NAME: IDE ACADEMY AT FANNIN
 ADDRESS: 4800 ROSS AVE
 PROPOSED USE: PUBLIC SCHOOL

CASE # (Z178-199)	
BUILDING DATA	
BUILDING USE	SCHOOL
CLASSROOMS	24
EXISTING BUILDING HEIGHTS	
ORIGINAL 3-STORY BUILDING	57'-8"
1978 2 STORY CAFETERIA	45'-6"
1990 2 STORY WING	45'-6"
1990 1 STORY GYM	20'-2"
CRANFIL HOUSE	23'-4"
PROPOSED BUILDING HEIGHTS	
NEW GYMNASIUM	28'-4"
BUILDING AREA	
1ST FLOOR	36,975
2ND FLOOR	16,973
3RD FLOOR	6,861
BUILDING TOTAL SQUARE FOOTAGE	60,809
EXISTING BUILDING FOOTPRINT	
EXISTING	36,975
ADDITION	6,200
TOTAL BUILDING FOOTPRINT	43,175 SQ FT
TOTAL LOT SQ FT	110,691 SQ FT
LOT COVERAGE	61%
ALLOWED LOT COVERAGE PER CURRENT PD	90%
PARKING	
	32 SPACES + 4 ACCESSIBLE SPACES

- ARCHITECT**
 HKS, INC.
 350 N SAINT PAUL ST, SUITE 100
 DALLAS, TX 75201-4240
- STRUCTURAL ENGINEER**
 AGAE STRUCTURAL ENGINEERING, PLLC
 15280 ADDISON ROAD, SUITE 310
 ADDISON, TX 75001
- MEP ENGINEER**
 SIMS ENGINEERING, INC.
 11700 PRESTON RD, SUITE 600 #194
 DALLAS, TX 75230
- LANDSCAPE ARCHITECT**
 CAYE COOK & ASSOCIATES
 12700 HILLCREST ROAD, SUITE 149
 DALLAS, TX 75230
- CIVIL ENGINEER**
 PACHECO KICH
 7557 RAMBLER ROAD, SUITE 1400
 DALLAS, TX 75231
- ROOFING CONSULTANT**
 DRYTEC ROOF CONSULTANTS
 8750 N CENTRAL EXPRESSWAY, SUITE 1730
 DALLAS, TX 75231
- FOOD SERVICE CONSULTANT**
 BOSMA DESIGN SOLUTIONS
 2201 LONG PRAIRIE ROAD, SUITE 107-727
 FLOWER MOUND, TX 75022
- OWNERS PROGRAM MANAGER**
 AECOM
 3801 HERSCHEL AVE.
 DALLAS, TX 75219

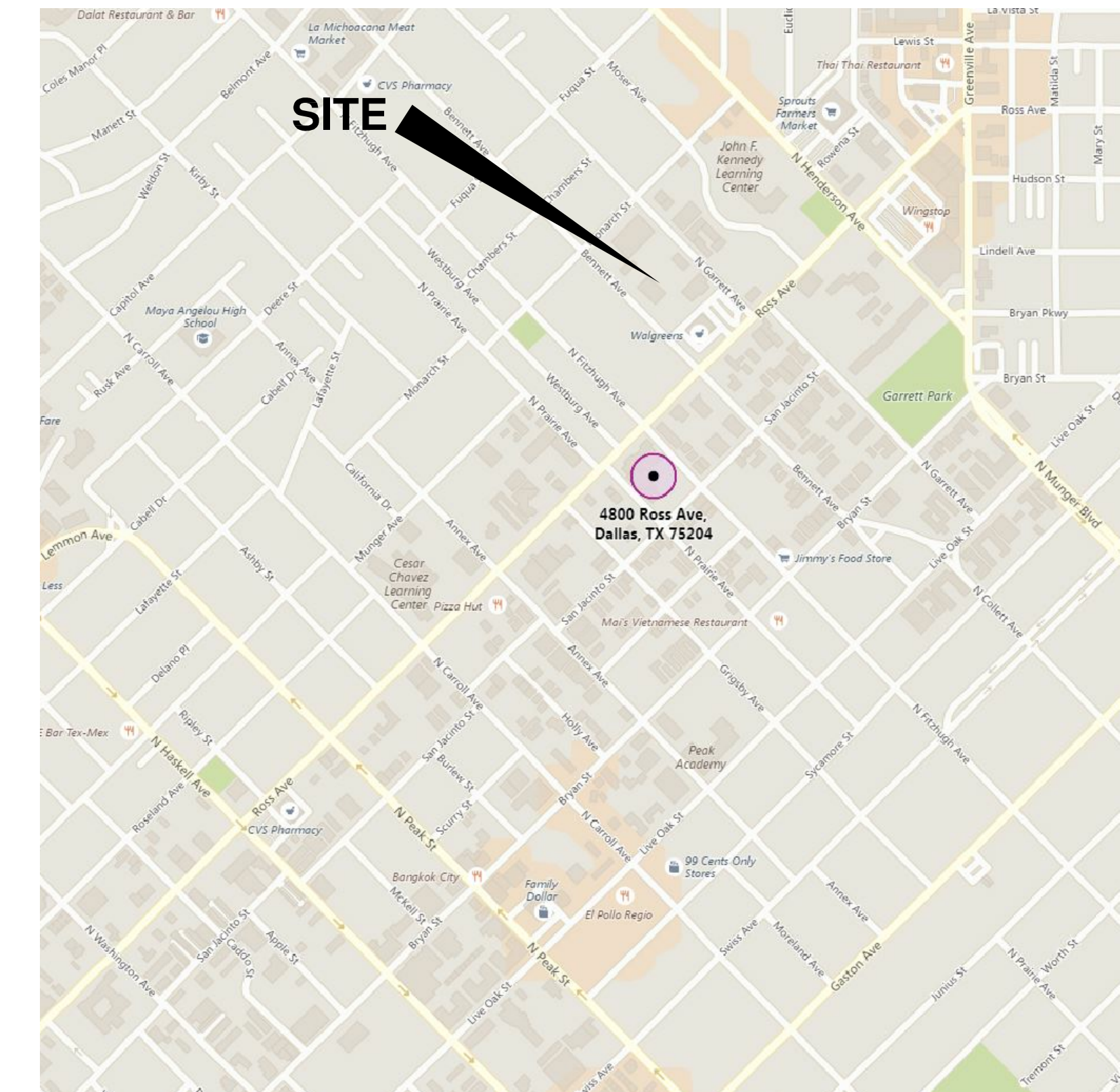
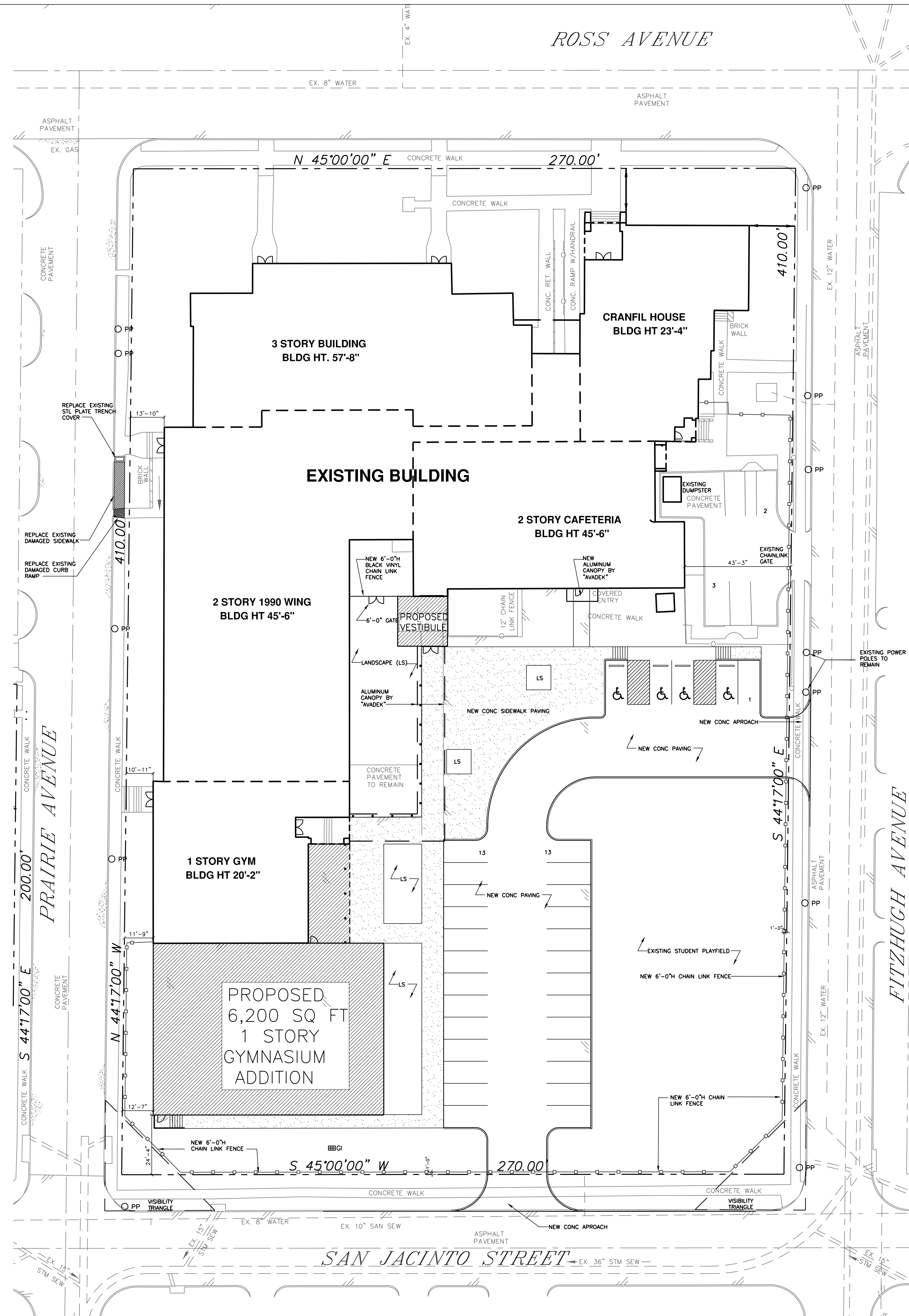

VICINITY MAP

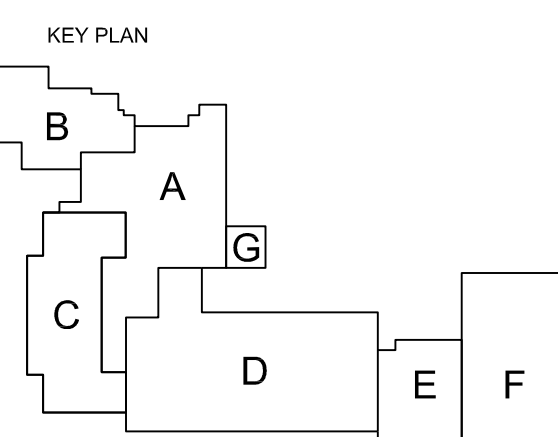

REVISION

HKS PROJECT NUMBER
21285.000
 DATE
05/08/2018
 ISSUE

SHEET TITLE
DEVELOPMENT PLAN

SHEET NO.
D1.01